

How to measure - Inside Square Corner "Lazy Susan" (Framed and Frameless)

- 1 Identify your cabinet box construction method as Framed or Frameless as shown in image 1.**

- a. If Framed, go to step 2.
- b. If Frameless, go to step 4.



Framed

A face frame is attached to the front of the cabinet box.



Frameless

No face frame is attached to the cabinet box.

Image 1

- 2 For Framed, determine your hinge overlay. Find a single door cabinet nearby (if none are available use default hinge overlay of 1/2" and move to step 3).**

- a. Measure the width of the door.
- b. Open the door and measure the width of the opening behind the door.
- c. Subtract the opening width (step b) from the door width (step a).
- d. Divide that number by 2 to get your hinge overlay. Write this number down.

HINGE OVERLAY

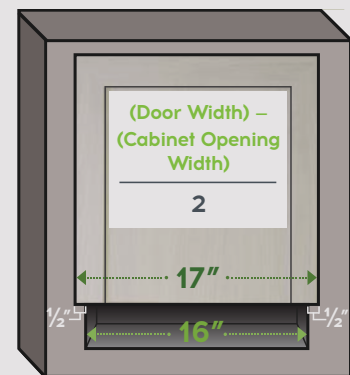

Image 2

- 3 Calculate the correct door size(s) to order for your cabinet.**

- a. Using a 1/2" overlay and doors that do not overlap where they meet in the corner.
 - Measure the width and height of the current doors.
 - These are the door sizes you need. You will need to order 2 of these to cover the opening.

- b. Unknown overlay or doors missing.

- Calculating Width

1. Measure the width of the opening from the frame to the inside corner (Dimension A & B) as shown in image 3.
2. Subtract 3/8" from the width you just calculated for each door.

- Calculating Height

1. If you have doors and/or drawers next to the opening, measure the total height from the top to the bottom.
2. If no doors exist, add 3/4" to the height of the opening. This is the door size you need. You will need to order 2 of these to cover the opening.

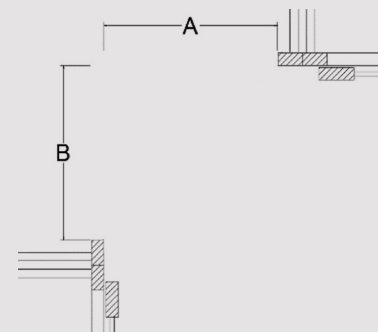

Image 3

- 4 For Frameless, determine the thickness of your cabinet box so we send the correct hinge plate.**

- a. Measure the thickness of your side panel (this is either 5/8" or 3/4").
- b. Measure the width and height of the current doors.
- c. These are the door sizes you need. You will need to order 2 of these to cover the opening.