

## You have these conditions:



**Existing Door  
or No Door  
Over 63"**



**Frameless  
Cabinet**

**NOTE 1:** Our maximum door size height is 63", for sizes larger you will need to order 2 doors.

**NOTE 2:** Your doors will be attached together using our mending kit.



### Determine your door front sizes:

1. Download our helpful form to record your information the same way our website will ask for it. [Measurement Form](#)
2. Measure your end panel thickness. It will be 5/8" (0.625") or 3/4" (0.75").
3. Use one of the following methods to determine the width and height of both doors. Measure to the closest 1/16" (0.0625").
  - For Existing Door:** measure the width and height of existing door.
    - Divide the height into 2 doors less than 63" each.
  - For No Door:** measure the width and height of cabinet opening.
    - **With 5/8" End Panel** - Add 1" to opening width and height. Divide the height into 2 doors less than 63" each.
    - **With 3/4" End Panel** - Add 1-3/8" (1.375") to opening width and height, Divide the height into 2 doors less than 63" each.
4. Write the dimensions of the doors you need on the measurement form.

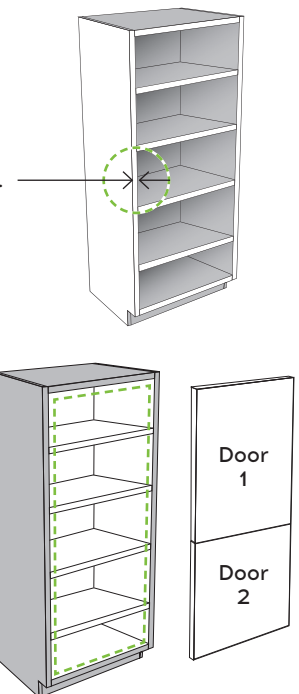

### What to order:

1. Order 2 doors to cover opening with the dimensions determined above.
2. Order the accessory item: **"I-O295 Mending Plate to Join Doors, with Screws."**